

INTERNATIONAL HANDICAP SYMBOL

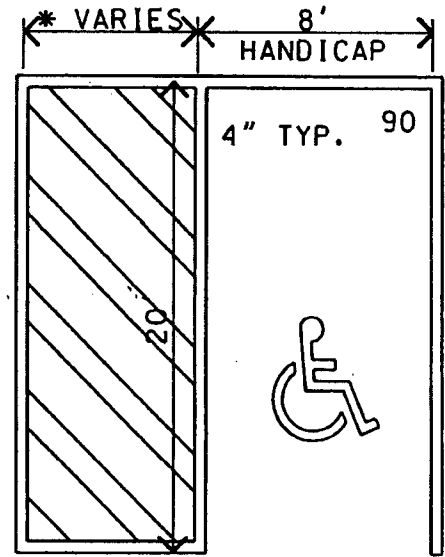

\* 5' STANDARD WIDTH  
8' VAN ACCESSIBLE

HANDICAP SIGN

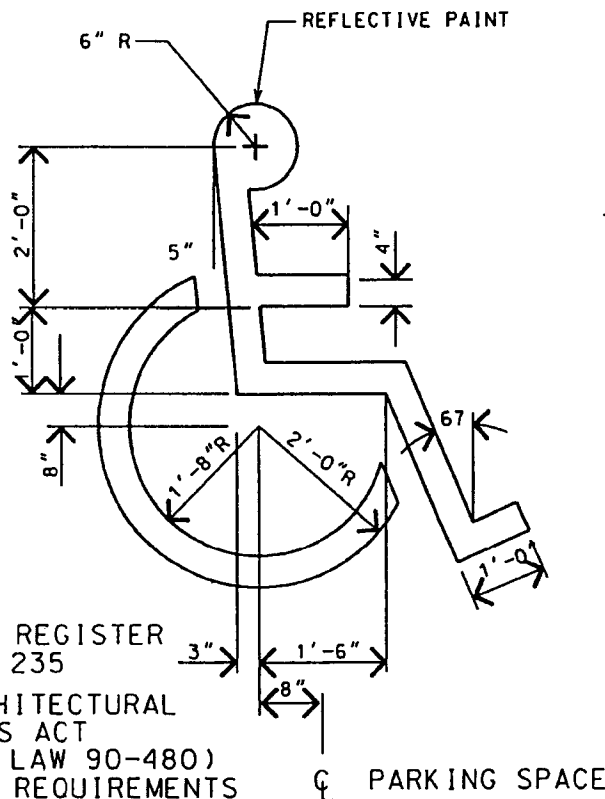

REFERENCES

1. FEDERAL REGISTER  
ACT NO. 235
2. THE ARCHITECTURAL  
BARRIERS ACT  
(PUBLIC LAW 90-480)  
AND ALL REQUIREMENTS  
LISTED BY THE AMERICANS  
WITH DISABILITIES ACT (ADA)

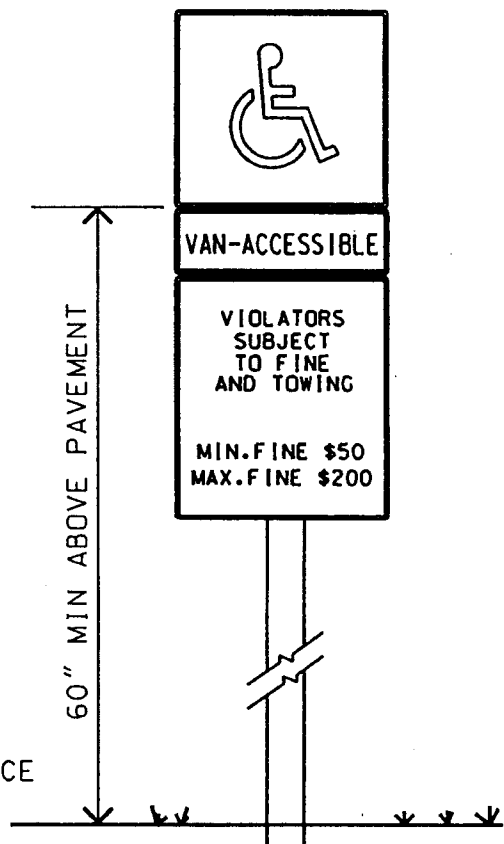

DATE: August 2009

Scale: N.T.S.

**TOWNSHIP OF PINE**  
**Standard Details**  
**Detail S-2**  
**Handicap Stalls**

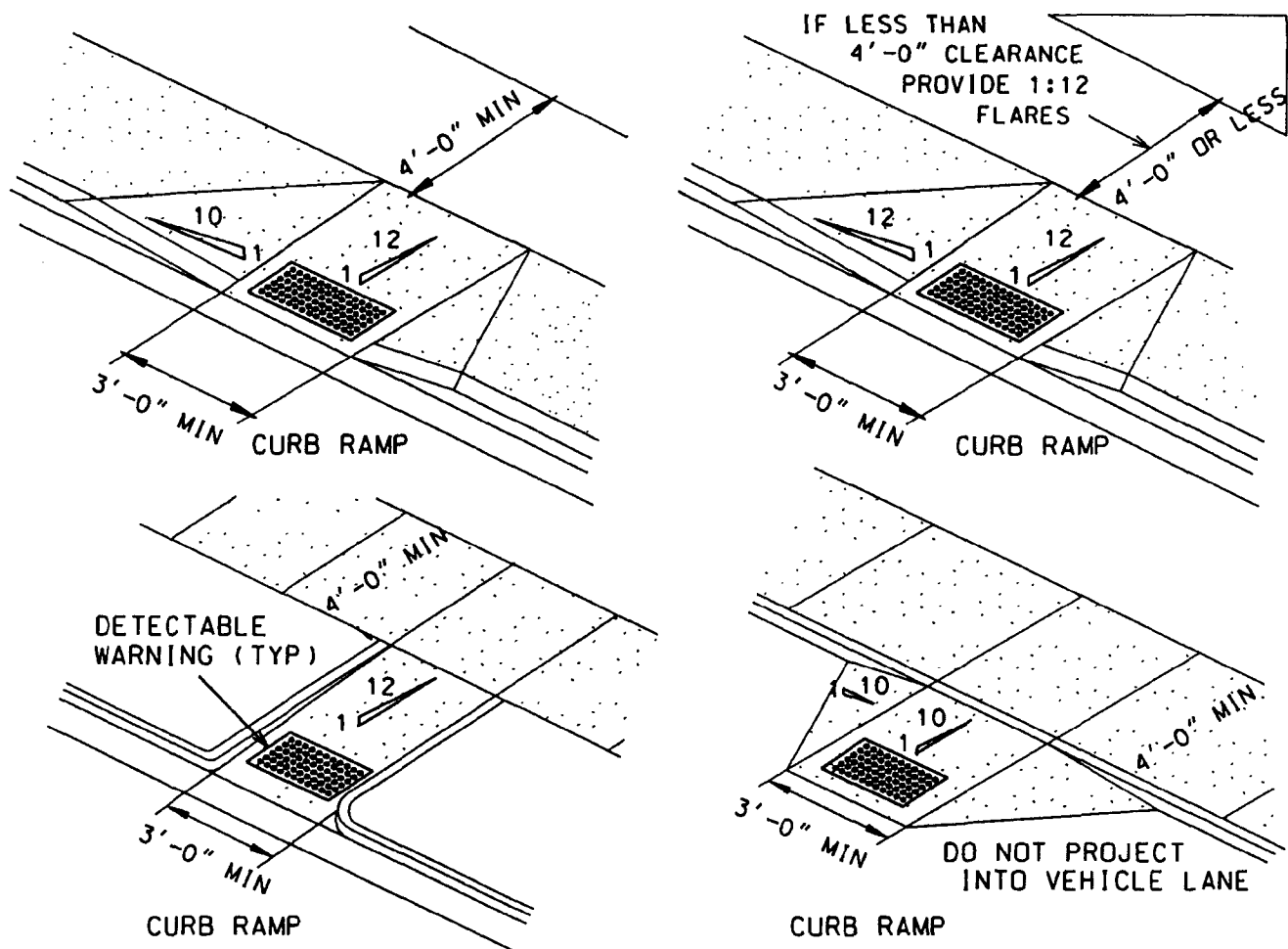

- CURB RAMPS SHALL BE PROVIDED WHENEVER AN ACCESSIBLE ROUTE CROSSES A CURB
- SLOPES OF CURB RAMPS SHALL NOT EXCEED 1:10. TRANSITIONS SHALL BE FLUSH AND FREE OF ABRUPT CHANGES.
- THE MINIMUM WIDTH OF A CURB RAMP SHALL BE 36", EXCLUSIVE OF FLARED SIDES
- THE MAXIMUM SLOPE OF A CURB RAMP FLARE SHALL BE 1:10
- BUILT-UP CURB RAMPS SHALL NOT PROJECT INTO TRAFFIC LANES
- CURB RAMPS SHALL HAVE DETECTABLE WARNING (TRUNCATED DOMES) IN ACCORDANCE WITH CURRENT ADAAG REQUIREMENTS
- CURB RAMPS SHALL BE PROTECTED TO PREVENT OBSTRUCTION BY PARKED CARS
- ANY RAISED ISLANDS IN CROSSINGS SHALL BE CUT THROUGH LEVEL WITH THE STREET
- RAMPS SHALL HAVE LEVEL LANDINGS AT BOTTOM AND TOP OF EACH RAMP
- IN ALL CASES THE AMERICANS WITH DISABILITIES ACT ACCESSIBILITY GUIDELINES (ADAAG) SHALL TAKE PRECEDENT OVER THESE STANDARD DETAILS

DATE: AUGUST 2009

Scale: N.T.S.

**TOWNSHIP OF PINE**  
**Standard Details**

**Detail S-3**  
**CURB RAMPS**

**PAGE-52**

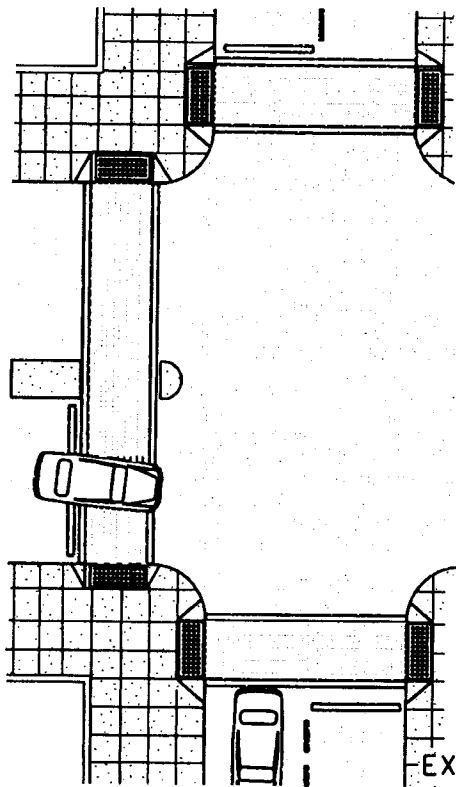

EXAMPLE A

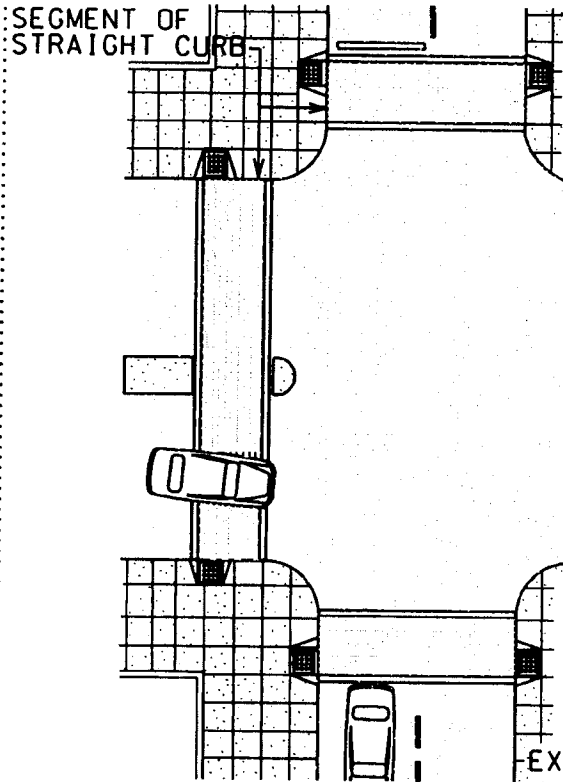

EXAMPLE B

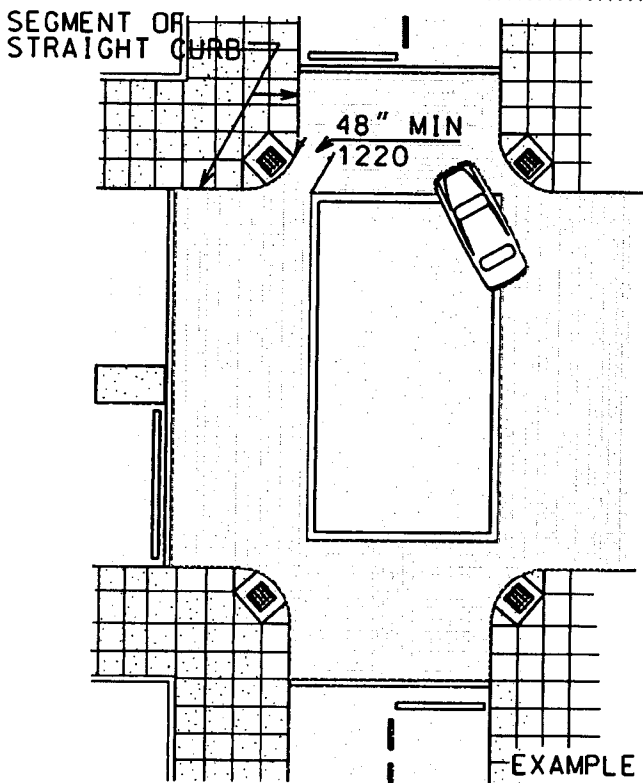

EXAMPLE C

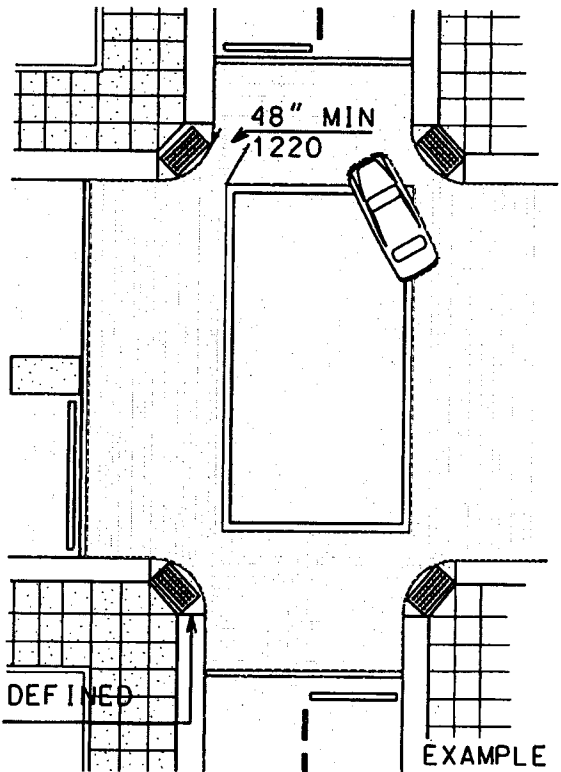

EXAMPLE D

DATE: AUGUST 2009

Scale: N.T.S.

TOWNSHIP OF PINE  
 Standard Details  
 Detail S-4  
 CURB RAMPS AT MARKED CROSSINGS PAGE-53